

### FEATURES

- Materials: 1.2mm cool rolled steel.
- Color: black/gray
- Features: 3 optional heights for choices.
- Surface finish: Degreasing, phosphoric, water cleaning, electro-static powder coating
- Installing: fixed by square nuts
- Installing position: vertical fixed on the mounting rail.
- Applications: shielding equipment inside, dust-pro, and making cabinet looking neat.

BLANK PANEL,Black or Gray,1U or 2U or 4U.

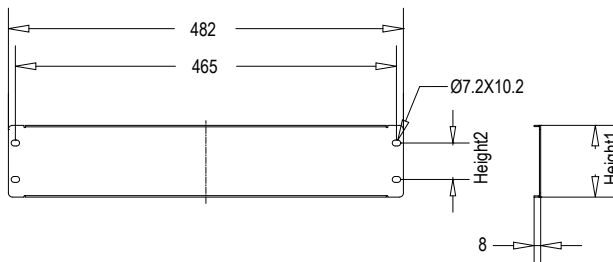

### ORDER INFORMATION

Part number	Description	Height1/mm	Heights 2/mm	Applications
CFG01-*	1U blank panel	43	31.8	19'cabinet
CFG02-*	2U blank panel	87.5	76.2	19'cabinet
CFG04-*	4U blank panel	177	101.6	19'cabinet

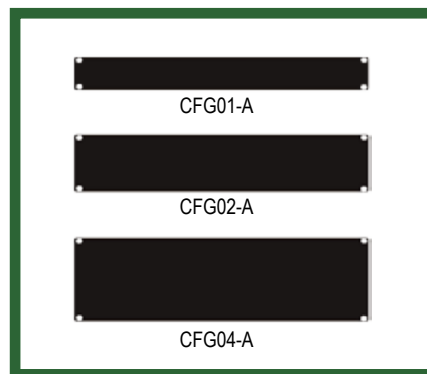

### COLOR

\* = Colors      A= Black(RAL9004)      B=Gray(RAL7044)

